

GalvinCare® CP-BS Lead Safe™ MH Vandal Resistant Ezy-Grip Basin Set with Hob Basin Outlet

PRODUCT CODE:
- 121.23.33.03

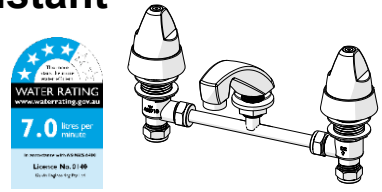

SPECIFICATIONS

- Designed for maximum protection against vandalism, GalvinCare® basin assemblies are made from heavy duty components.
- The basin assembly is finished in bright chrome plate for easy cleaning and durability.
- Quarter turn ceramic disc.
- Lead Safe™ brass construction. *

IMPORTANT: All GalvinCare® Ezy-Grip basin sets are tested in accordance with AS 3718 and leave our premises in good working order.

*Our Lead Safe™ product range is compliant with the Lead Free Requirements of the NCC 2022 Vol. Three, Clause A5G4(2) and NSF/ANSI 372.
**Any flow controller incorporated in the outlet to be tightened to prevent removal by hand. As Per AS3718.

WARNINGS: Special attentions to be paid on notes, photos, images, or drawings of assembly steps marked with the warning symbol. 

TECHNICAL DATA

Inlet	1/2" CU / BSP	
Outlet	Aerator	
Headwork	Ceramic	
Working Pressure Range (kPa)	Min	50
	Max	500
Working Temperature Range (°C)	Min	5
	Max	65
Nominal Flow Rate (LPM)	7	
Finish	Chrome	

NOTE: Galvin Engineering continually strive to improve their products. Specifications may change without notice.

TOOLS REQUIRED

- Power drill
- Spanner or adjustable crescent
- Thread tape/sealant

PRE-INSTALLATION - MOUNTING DETAILS

- If the mounting holes do not already exist, mark out and drill the holes in the bench/trough, as shown in rough-in dimensions.

! Note: Distance between outlet and basin bodies is 218mm maximum.

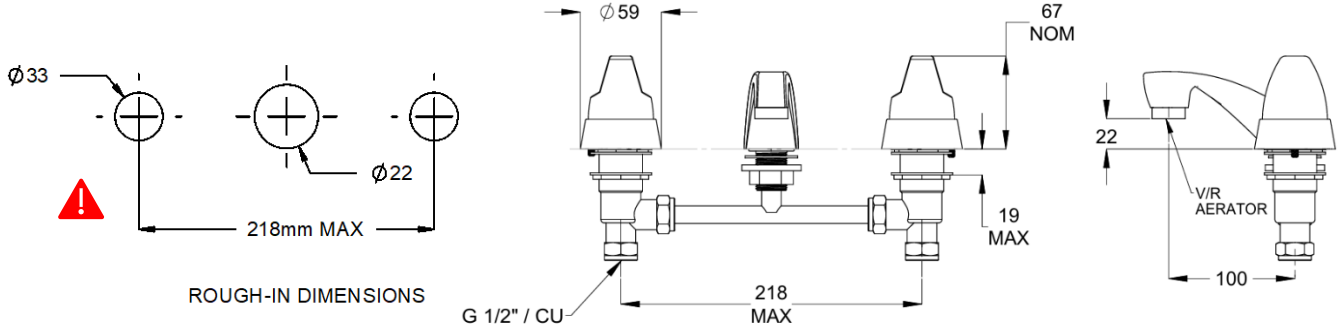

INSTALLATION

INSTALLATION COMPLIANCE: Galvin Engineering products must be installed in accordance with these installation instructions and in accordance with AS/NZS 3500, the PCA and your local regulatory requirements. Water and/or electrical supply conditions must also comply to the applicable national and/or state standards. Failing to comply with these provisions shall void the product warranty and may affect the performance of the product.

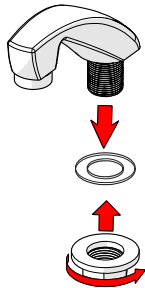

1. Fit spout

- Fit the GalvinCare® Basin spout into the bench.
- Ensure the sealing washer is placed underneath the base body.
- Position the spout to the front and secure underneath with the supplied flanged back nut.
- Take care not to over-tighten.

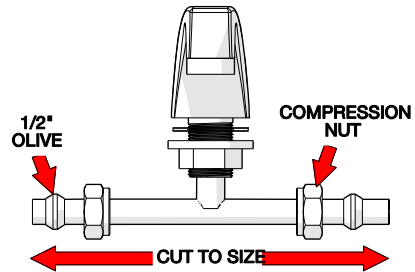

2. Cut copper breach

- Measure the distance between the basin body holes.
- Mark out the base copper tee using this measurement, subtracting 15mm from each end to allow for the basin body compression nuts.
- Ensure there is an equal distance from the centre.
- Cut to size with pipe cutter and de-burr both ends.

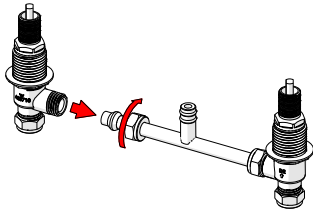

3. Fit basin bodies to breach

- Assemble basin bodies to the copper breach
- Ensure the olive is positioned over the copper breach for sealing.
- Tighten the compression nut, taking care not to overtighten as this may damage the olive.

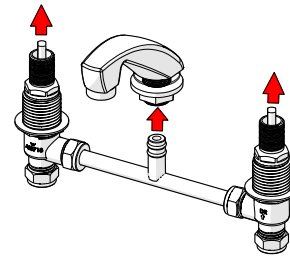

4. Fit basin body assembly

- Insert the basin body assembly up through the pre-cut holes.
- Center the basin bodies.
- Carefully insert the copper breach into the spout to avoid damage to the o-rings.

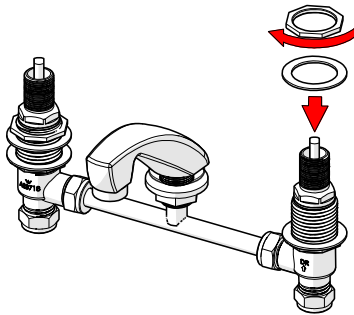

5. Secure basin body assembly

- Secure the basin body in place with supplied washer and locking nut.
- Ensure that the set is installed with hot and cold in the correct location.

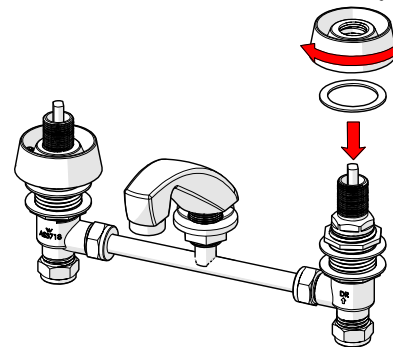

6. Fit dress flanges

- Fit washer onto dress flange and tighten.

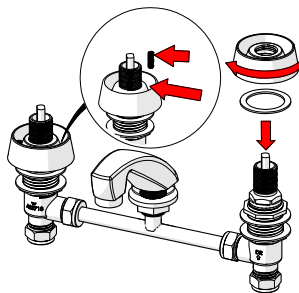

7. Fit dress flange with anti-rotation pin

- If the anti-rotation option is required, fit dress flanges onto body and mark the basin/sink, remove the flange and drill 3/16" hole
- Replace the flanges and screw in the grub screw to lock.

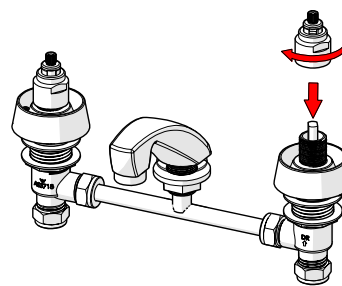

8. Fit lock sleeves

- Fit lock sleeves and tighten to lock entire unit in position.
- Take care not to over tighten.

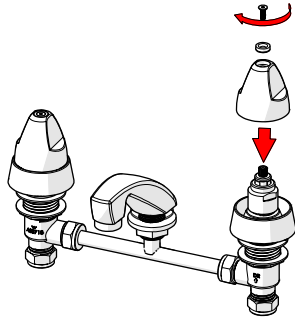

9. Assemble handles

- Fit handles with tamper proof screws, ensure the correct water temperature identification buttons are in the handle
- Screws must be tightened before the unit is tested

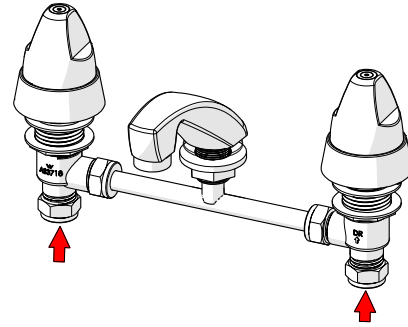

10. Testing

- Connect water supply to basin body inlet.
- Turn the handles and ensure that there is flow from outlet.
- Inspect the tap and check for any leaks.

TROUBLESHOOTING

PROBLEM	CAUSE	RECTIFICATION
Water is not flowing from tap	Water supply not on	Turn water on
	Aerator or flow regulator is blocked by debris	Remove aerator or flow regulator from tap and remove debris. Install an inline strainer to stop further blockages.
Taps are dripping water	Ceramic cartridge is worn or damaged	Remove and inspect the cartridge, remove debris and /or replace cartridge if damaged
	Tap seat is damaged	Refurbish tap seat using a reseating tool
Handle is loose	Screw has come loose	Tighten handle screw
Flange does not screw down onto basin surface	Tap body are set too far out	Re-position tap body and breach piece

WARRANTY

Galvin Engineering products are covered under our Manufacturer's Warranty. Galvin Engineering products must be installed in accordance with the installation instructions and in accordance with AS/NZS 3500 and NCC Volume Three, relevant Australian Standards and local authorities applicable to product being installed. Water and electrical supply conditions must also comply to the applicable national and/or state standards, failing to comply with these provisions may void the product warranty and affect performance of the product.

Please visit www.galvinengineering.com.au to view the full warranty, our Installation Compliance and Maintenance & Cleaning information as well as any other additional information.

DEFINITIONS AND DISCLAIMER

Galvin Engineering manufactures a range of products marked as Ligature Resistant or Vandal Resistant. Please visit www.galvinengineering.com.au to read the definition of these terms and the disclaimer that applies to these products.